

# Key Systems

Small Format Interchangeable Core (SFIC)  
Mortise and Rim Cylinder Housings

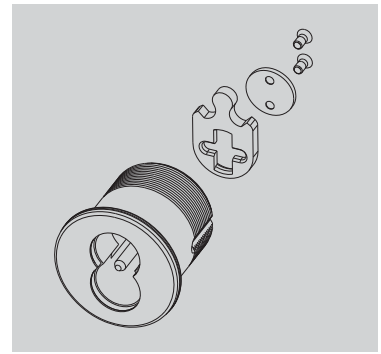

## Corbin Russwin Introduces Small Format Interchangeable Core [SFIC] Housings

The new SFIC housing is designed to work with both Corbin Russwin mortise and exit trim hardware and will accept all SFIC cores. The housing is made to Corbin Russwin specifications using Corbin Russwin mortise cams and exit trim cylinder tail pieces ensuring all functions work flawlessly.

SFIC housings are made at the Corbin Russwin factory, ensuring that the hardware functions properly when used with SFIC cores provided by others.

### Features and Benefits:

- SFIC housings are made from solid brass and incorporate a cylinder scalp to match any architectural finish.
- Small Format Interchangeable Core [SFIC] lock systems are ideal for rekeying locks quickly and easily versus standard fixed cores.
- Corbin Russwin offers SFIC prepped knobs and levers for cylindrical locks and SFIC housings for all Mortise locks and Exit devices.
- SFIC cylinder housings are manufactured with the same precision as Corbin Russwin LFIC cylinders.
- All Corbin Russwin hardware is now compatible with all SFIC cores

### Corbin Russwin SFIC Housing Only

Cylinder Type	Mechanism	Function	Length	Cam	Pins
10 Mortise	4 SFIC (Housing Only)	0 Standard	(Mortise Cylinder)	A01 Cloverleaf	6 (Standard) 7 (Available only for 1-3/8" - 1-3/4")
30 Rim			114 1-1/4"	A02 Straight	
43 DL3100			138 1-3/8"	A03 Adams Rite® MS	
			112 1-1/2"	A04 DL4000 Series	
			134 1-3/4"	A05 Adams Rite 4070	
			(Rim Tailpiece)	A06 Schlage® Cloverleaf	
	058 5/8"	A07 DL4100			
	178 1-7/8"	A62 MR Straight			
		A93 Obsolete Deadlocks: Corbin® 610 Series and Russwin® 1403 Series			

**Note:** Additional information and the full range of cams compatible with the Corbin Russwin SFIC Mortise Housings are located in the Key Systems catalog.

### How to Order Housing Only:

1040 - 114 - A01 - 6 x Fin Mortise SFIC Housing; 1-1/4" length, A01 Cam, 6 pin  
 3040 - 178 - 7 x Fin Rim SFIC Housing; 1-7/8" tailpiece length, 7 pin  
 4340 - 214 - A1 x Fin Deadlock SFIC housing; 2-1/4" (57mm) Door

product bulletin

# Key Systems

Small Format Interchangeable Core (SFIC)  
Mortise and Rim Cylinder Housings

## SFIC Housing Quick Codes

Type	QC		CL <sup>1</sup>	ED	ML
SFIC	CLS6	SFIC 6-pin with Less Core		x	x
SFIC	CLS7	SFIC 7-pin with Less Core		x	x
SFIC	CT6SD	SFIC 6-pin with SFIC disposable temporary core		x	x
SFIC	CT7SD	SFIC 7-pin with SFIC disposable temporary core		x	x
SFIC	CTSD	SFIC 6- or 7-pin Small Format Disposable Core	x		
SFIC	M08	Best® (SFIC) 6 or 7-pin Interchangeable Core Lever	x		

1. Specify M08 for levers to accept SFIC cores; which ship standard with temporary disposable core

## How To Order Examples with hardware:

Quantity	Series/Function	Trim	Finish	Hand	Cylinder Option	Other
24	ML2055	123Y	619	RH	CLS7	-
36	ML20605 TCRNE1	102X	618	LH	CT6SD	M802
12	CL3351	FZD	605	RH	M08	-
8	CL33605 TCRNE1	NZD	626C	RH	M08, CTSD	M802
12	ED5200S	123955	619	RHR	CLS6	M60
12	ED5200SA	VT957	630	RHR	CT7SD	-

Corbin Russwin SFIC Housings use standard Corbin Russwin cylinder components.

